



Fire Products & Solutions

The New **3000 Series** Full Circle Protection

Intelligent Simplicity

Intelligence in every alarm
Simplicity for every install







Fire Products & Solutions



Brooks specialise in smoke, heat and carbon monoxide protection

- it's all we do and have done for the past 30 years.

Brooks smoke, heat and CO alarms are tested multiple times during the manufacturing process.

By fitting Brooks alarms you can be confident you're getting the best protection.

Tried, tested, trusted.

The 3000 Series

Full Circle Protection

The new 3000 Series provides complete property coverage from one series. This technologically advanced series detects both Fire and Carbon Monoxide (CO), ensuring your whole property is protected.

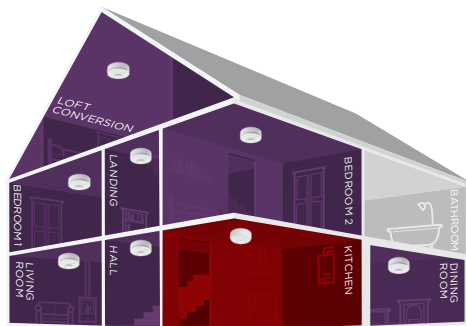

Simplicity for every install



Specify a whole property from one series



Quick and reliable interconnection



Easi-fit bases; one base fits all



Backwards compatibility



The 3000 Series is our most **intelligent** series yet, whilst maintaining the **simplicity** our customers value.

Intelligence in every alarm



It's here

- the Multi-Sensor Heat & Carbon Monoxide Alarm

There are a number of Fire & Carbon Monoxide (CO) risks within a typical home. For example, cookers in kitchens pose a fire risk, being responsible for 50% of accidental fires in dwellings. In addition, many of

these areas also contain gas fuelled appliances which present an additional risk from CO - a poisonous gas that you can't see, smell or taste.



**It's vital to protect
against both risks.**

Previously, the answer to this would have been to fit two alarms, a heat alarm and a CO alarm, however this protection can now easily be achieved by using the new EIB3028 Multi-Sensor which detects both Fire and Carbon Monoxide in a single alarm.

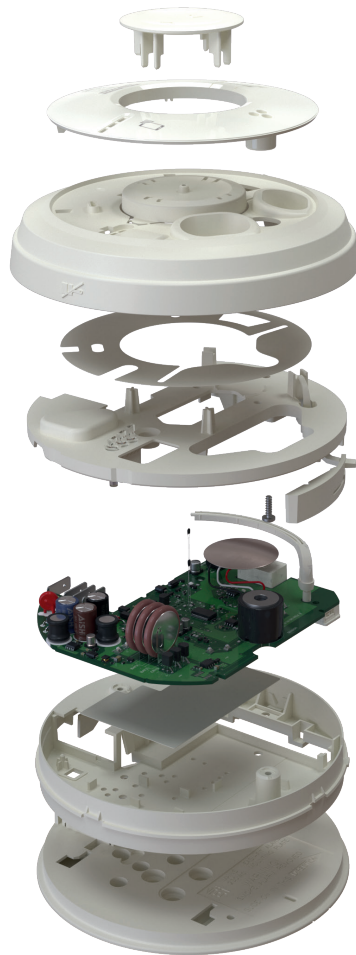

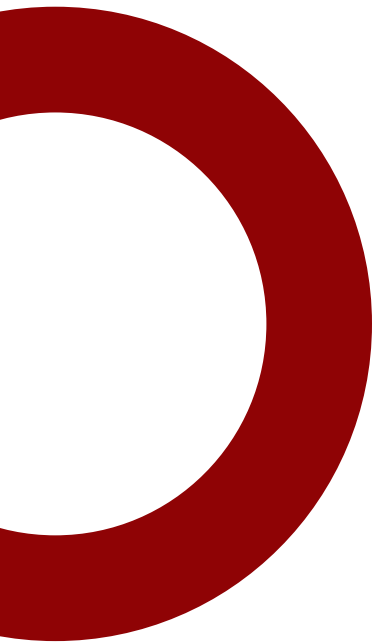

The alarm
contains our
tried and tested
thermistor heat
sensor and
our **proven**
electrochemical
CO sensor,
providing **protection**
from both Fire and CO.

The EIB3028 Heat & CO alarm is built with the same high quality, reliable and proven technology as in our other Heat and CO alarms but combined in one alarm and with advanced intelligent technology.

Benefits of the EIB3028 Multi-Sensor Heat & CO alarm

- ✓ **Install one alarm** instead of two for combined Fire & CO coverage
- ✓ **Contains two proven, reliable sensors**
- ✓ **Flashing Fire and CO indicators**
- ✓ **Easy to install** – simply slide the new alarm onto an existing **easi-fit** base
- ✓ **Compatible with SmartLINK[®] wireless interconnection** using our award-winning RF technology for simple system set up, house-coding and system expansion
- ✓ **Real time local data extraction using AudioLINK[™]**
- ✓ **Fully backwards compatible with existing Brooks systems**



Total Fire Coverage...

Smoke alarms have different sensors to detect different fire types. With the EIB3024 Multi-Sensor alarm, sensor choice is simple as this alarm provides total fire coverage. Its combination of a Heat and a Photoelectric sensor means that it can detect all fire types.

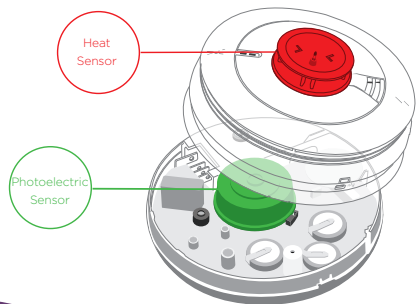

Multi-Sensor

AS3786:2014 + A1:2015 + A2:2018
AS1603.3:2018

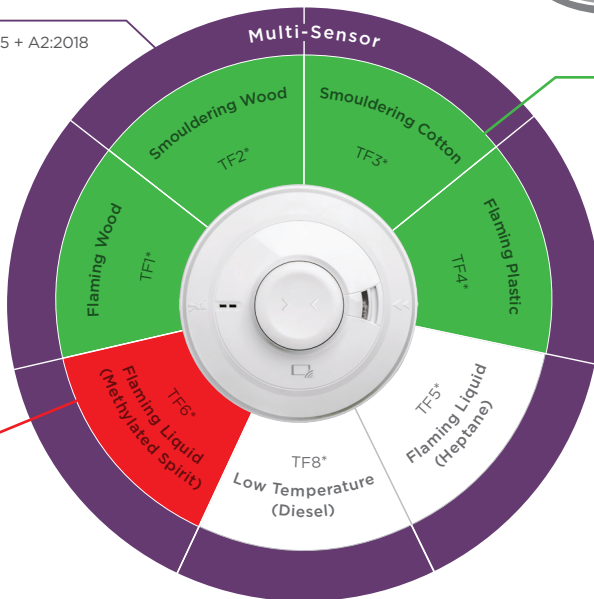

Photoelectric

AS3786:2014 + A1:2015
+ A2:2018



Heat

AS1603.3:2018



...with the **EIB3024**



The alarm provides total coverage to all fire types by actively monitoring both sensors. If a temperature rise is detected, the intelligent alarm software increases its sensitivity to smoke, detecting the fire quicker and more accurately.



Data sent between dual sensors monitoring heat and smoke levels



If a rise in temperature is detected by the heat sensor...



...data will relay to the photoelectric sensor, increasing its sensitivity to smoke





Benefits of the EIB3024 Multi-Sensor alarm

- ✓ **Contains two proven, reliable sensors**
- ✓ **Intelligent software** allows the sensors to work together
- ✓ **Easy to install** - simply slide the new alarm onto an existing **easi-fit** base
- ✓ **Compatible with SmartLINK[®] wireless interconnection** using our award-winning RF technology for simple system set up, house-coding and system expansion
- ✓ **Real time local data extraction using AudioLINK[™]**
- ✓ **Intelligent dust compensation** and mesh insect shield around the Photoelectric sensor to reduce false alarms
- ✓ **Fully backwards compatible with existing Brooks systems**

Meet the rest of the **3000 Series**



Benefits of all alarms in the 3000 Series

- ✓ **Mains powered** with a 10-year rechargeable lithium battery back-up
- ✓ **Real time local data extraction** using  **AudioLINK™**
- ✓  **SmartLINK®** capability for wireless interconnection and data extraction
- ✓ All alarms in the series fit on  **easi-fit** bases
- ✓ **Combined test/silence button**
- ✓ **5 year guarantee**
- ✓ **ActivFire listed** 
- ✓ **Designed and manufactured in Europe**



EIB3018

CO alarm (single sensor)

Contains our proven electro-chemical sensor and for the first time, this CO alarm fits on our *easi-fit* base.



EIB3016

Photoelectric alarm (single sensor)

Intelligent dust compensation and insect mesh shield for reduction of false alarms



Hallway



Landing



Living Room



Dining Room



EIB3014
Heat alarm (single sensor)

Fast response thermistor
(triggers at 58°C)



Kitchen



Garage

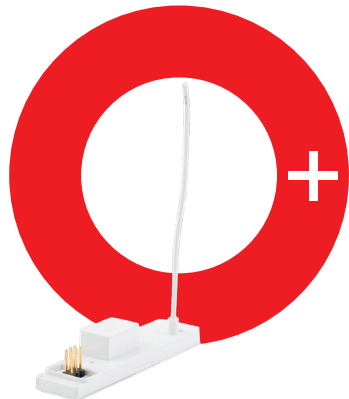

EIB3000MRF
SmartLINK module

The  **SmartLINK**® module allows for wireless interconnection and data extraction. Simply plug in to any 3000 Series alarm head.



The **next** **generation** of Radio Frequency Wireless Interconnection

With the introduction of the 3000 Series we have also advanced our award-winning Radio Frequency (RF) wireless interconnection and data extraction technology.

We've made it smarter, easier and future-proof. We've taken our renowned RadioLINK+ technology and added a new range of functions and features.

Wireless Interconnection

The new SmartLINK technology still provides the same proven wireless interconnection technology as RadioLINK and RadioLINK+, using radio frequency signals and is completely compatible with both existing systems.

- ✓ **No need for tricky cable runs,** alarms interconnect using radio frequency signals
- ✓ **Expand existing systems easily** by adding in SmartLINK technology
- ✓ **When one alarm is triggered, all others sound for audibility throughout the property**
- ✓ **Achieve remote whole-system data extraction** when access is not possible

To add SmartLINK technology to your system, simply plug SmartLINK modules into any 3000 Series alarm head.





House Coding

To ensure all the alarms in your system sound when one is triggered, they must be house coded together. When house coded, the alarms will learn each other as a system to ensure secure interconnection and no cross-signals with any neighbouring systems. We've made house coding as simple as possible to reduce time at install, whilst keeping it secure and reliable. For more information visit www.brooks.com.au

Remote House Coding

Want to expand a system with extra alarms for increased coverage? Not only do you no longer have the disruption of running new interconnect cable, you now also save time at install as we've made house coding new alarms to an existing system even quicker and easier.

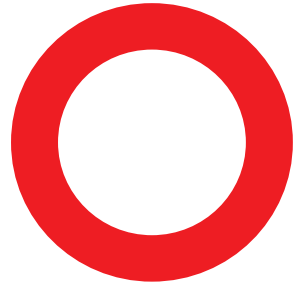

Coming Soon...

SmartLINK will soon enable real-time configurable notifications of alarm activations and events via a Gateway and Portal system. This will allow real-time notifications via email or text as well as full visibility of

your connected SmartLINK systems. Due to the depth of detail this will provide, reporting tools will enable to you forecast alarm replacement and maintenance requirements.





Real time facts... Real time action

The entire 3000 Series contains AudioLINK technology, which allows you to extract real time data from the alarm using its sounder directly to a smartphone or tablet via a free App.

AudioLINK can be used:

- ✓ As part of the property checks prior to change of tenants
.....
- ✓ To generate real time information if a tenant reports an issue with the alarms
.....
- ✓ To keep a record of the alarm's history
.....
- ✓ As an asset management tool
.....



Extracting the Data

Extract the data from the alarm to generate a real time Alarm Status Report in 3 easy steps:



STEP 1

Press the test button on the alarm 3 times

STEP 2

The alarm will emit a number of beeps. The phone/App will pick these up (via the microphone)

STEP 3

The phone/App will show the Alarm Status Report

The Alarm Status Report

The Alarm Status Report generated will be for the life of the alarm so far. It is colour coded to identify the urgency of any issues. This information can be used to tell

if there are any immediate issues with the alarm, for example if the alarm is coming to the end of its life, and deal with them directly.

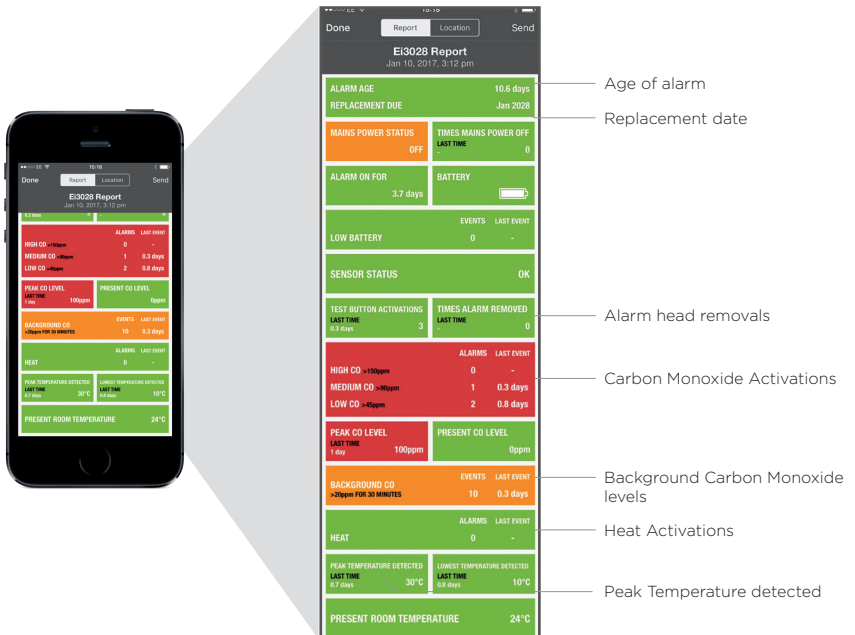



Report Storage and Sharing

Reports can be saved and emailed directly from the phone or tablet to one or multiple addresses, being sent as a PDF report or exported

as a .CSV file for simple integration with housing management and maintenance systems.

Benefits of AudioLINK

- ✓ **Data can be extracted simply** by using a smartphone/tablet and our free App
- ✓ **Extraction can be done on-site, with an alarm in-situ**
- ✓ **Can save time for response** as the contractors are on-site and able to gain access to real time fact
- ✓ **Data can be extracted multiple times**
- ✓ **Data is stored for the life of the alarm** enabling historic information to be retained
- ✓ **Alarm Status Report provides evidence** required for maintenance of records

And saves time, money and lives

Dust Compensation. Responsive Safety.

Brooks' dust compensation mechanism ensures best performance and best value.

- ✓ **Reduces false alarms**
- ✓ **Reduces maintenance costs**
- ✓ **Reduced number of unit replacements**
- ✓ **Ideal when access for maintenance is difficult**

The new Multi-Sensor alarm EIB3024 and Photoelectric EIB3016 have unique self-monitoring dust compensation, which will allow

the alarm to tolerate up to twice as much dust contamination than a conventional photoelectric alarm. The photoelectric sensor chamber continually self-monitors minute changes in dust levels. If the dust accumulates to a certain level, the alarm automatically compensates to stop false alarms but also continues accurate smoke detection. The sensor has multiple stages of compensation allowing it to adjust throughout the alarm's life. Additionally, if the alarm is cleaned with a vacuum, eliminating the dust, the alarm automatically resets the compensation settings.

Automatic recalibration

The alarm automatically recalibrates the alarm trigger point to compensate for dust, retaining a constant threshold between the dust level and the amount of smoke needed to trigger the alarm.

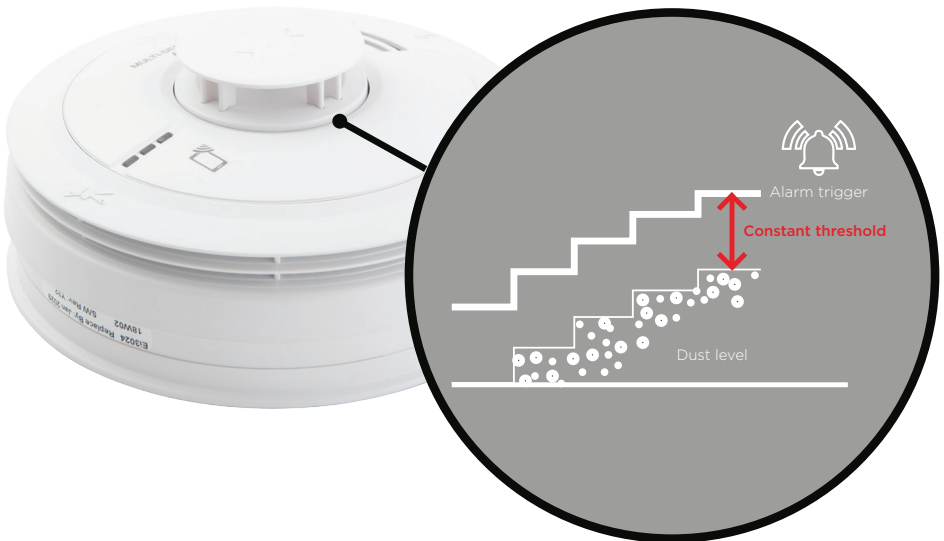



Designed by installers. Delivered by Brooks.

All alarms in the 3000 Series use our renowned easi-fit base. This includes the EIB3018 CO alarm, our first ever CO alarm on an easi-fit base which means you can now install an entire property, from one series, on the same base.

By maintaining the same footprint, it is easier and quicker for installers

to swap an older Brooks alarm for a 3000 Series alarm. Simply slide off the old alarm and slide on the new 3000 Series alarm. The easi-fit base continues to give quick, reliable installation of new alarms also. All the features that we included from our Installers' feedback still make for our best base design yet.

Align with
previous
installations



Larger
terminals

No.8 Screws
can now
be used



Trunking
Pull-out

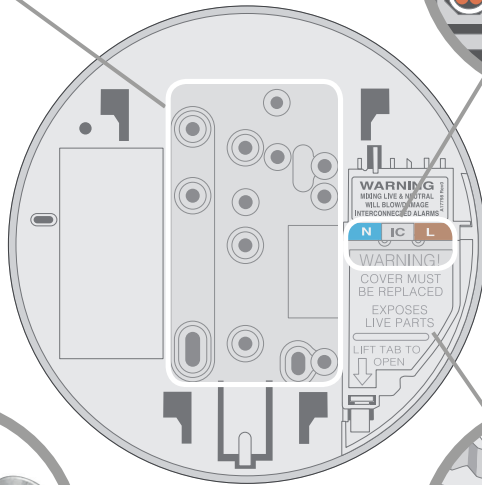
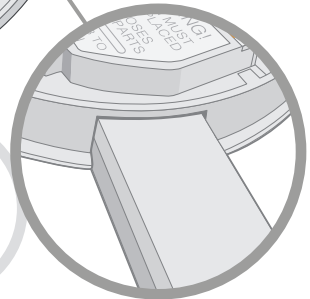



Compatible Accessories

Add the EIB3000MRF for wireless interconnection to...

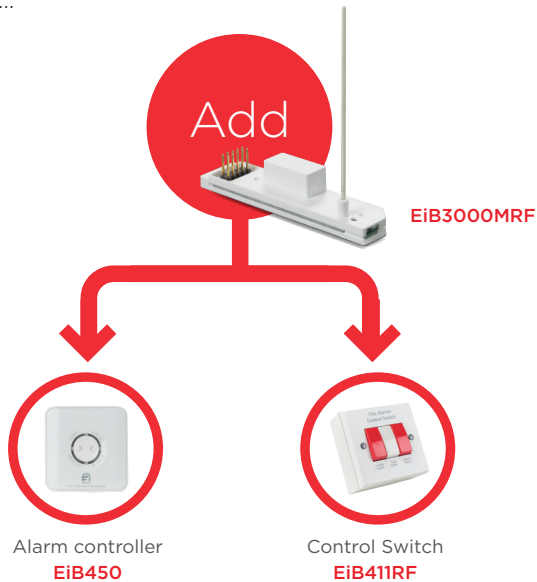

Additional accessories are available.
See www.brooks.com.au for more information.

Need further support?

Visit our website for further information www.brooks.com.au

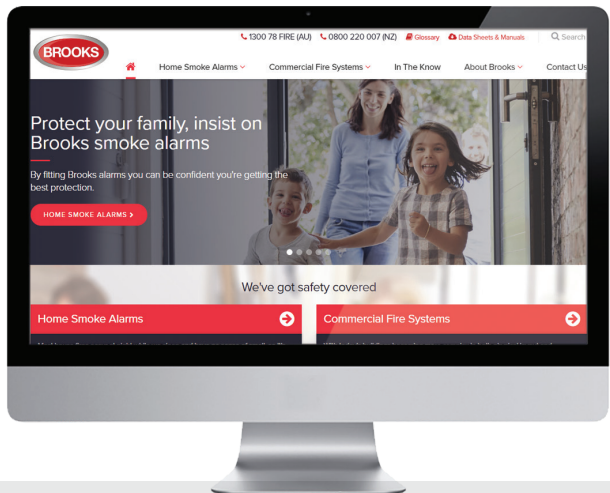

About Brooks

Innovation

Innovation, quality and performance are the life blood of Brooks. All the alarms and accessories are not just manufactured in the factory, but are

developed with input from Brooks and the customer feedback Brooks have gained.

Quality

Brooks are committed to providing the highest quality Smoke, Heat and Carbon Monoxide alarms designed to provide the most reliable life-saving detection. All alarms are manufactured at the Ei Electronics

factory in Shannon, Ireland. During the manufacturing process, every single alarm is tested at multiple points to ensure consistent high quality and ultimately reliability across all products.



Performance

We pride ourselves on our customer service. We have a team of Territory Sales Managers across Australia on hand to support you with everything from alarm selection guidance to advice on install as well as supporting wholesaler branches.

Our internal sales team also provide over the phone support as well as ensuring orders are dealt with correctly and promptly. The technical team can support you with any more complicated queries and to aid you with specifications if needed.

Acknowledgements

© Brooks Australia Pty Ltd. Illustrations, photographs, part numbers, layout and style are considered property. Any reproduction, in whole or in part, is strictly prohibited without written permission.

Our policy is one of continuous improvement; we reserve the right to amend designs and specifications without prior notice. Every care has been taken to ensure that the contents of this document are correct at the time of printing and we shall be under no liability whatsoever for any errors or omissions.

Need to contact us?

Australia Offices

1 Sydney - Head Office
salesnsw@brooks.com.au

2 Melbourne
salesvic@brooks.com.au

3 Brisbane
sales.qld@brooks.com.au

4 Adelaide
salessa@brooks.com.au

5 Perth
saleswa@brooks.com.au

6 NZ
salesnz@brooks.com.au

1300 78 FIRE





Fire Products & Solutions

Brooks Australia Pty Ltd

4 Pike Street
Rydalmere NSW 2116

1300 78 FIRE

www.brooks.com.au

© Brooks Australia Pty Ltd. Illustrations, photographs, part numbers, layout and style are considered property.

Any reproduction, in whole or in part, is strictly prohibited without written permission. Our policy is one of continuous improvement; we reserve the right to amend designs and specifications without prior notice. Every care has been taken to ensure that the contents of this document are correct at the time of printing and we shall be under no liability whatsoever for any errors or omissions.