

## DATASHEET

### FIRE PANELS - ACCESSORIES

#### Enclosed Addressable Manual Call Point with Isolator

- Attractive design & Built-in short-circuit isolator. IP rating IP56
- Test key for routine testing without breaking the frangible element



#### GENERAL

The manual call point (m.c.p.) has an attractive design compliant with EN54-11, and is surface mounted in the supplied red back-box. To operate the m.c.p. the frangible element is pressed until it is broken. This will activate the built-in microswitch, which will generate a fire alarm in the c.i.e. The frangible element is easily replaced. The m.c.p. also has a built-in short-circuit isolator.

#### TEST / COVER REMOVAL KEY

Routine testing is made without breaking the frangible element by inserting a supplied test key. The m.c.p. will be reset when the test key is pulled out. The test key is also used for the front cover removal.

#### PROTECTIVE COVER

To protect the m.c.p. against accidental operation, a transparent flap has to be lifted to get access to the frangible element.

#### ENCAPSULATED CIRCUIT

All electronics are encapsulated. Only the terminal block is accessible from the rear. Mounted in the supplied red back-box with the tightening gasket in place (see the opposite page), the IP rating is IP56.

#### LED INDICATOR

**LED steady on** indicates that the m.c.p. is operated, i.e. fire alarm is activated in the c.i.e. **Flashing LED**, see **Connection / Settings**.

## BUILT-IN ISOLATOR

The isolator, compliant with EN54-17, will divide the COM loop into **segments**, i.e. between two isolators or between an isolator and the c.i.e.

In case of a COM loop short-circuit only the affected segment will be disabled. Depending on the mode, the isolator will be in use or not.

## CONNECTION / SETTINGS

The m.c.p. and the isolator takes only one COM loop address. The mode of addressing and technical address are set with the address setting tool 3314/4414 as follow:

- > **NORMAL** mode, only if isolator is required, type must be programmed as 4439. Valid for FT1020G3 and FT128 software version  $\geq 2.0$
- > **2330** used if the isolator is not required. Must be programmed as 3339 via EBLWin or WING3/512/128

Two flying leads (wires) are connected to the terminal block and shall be used for the address setting tool's connection cables only. The wires shall be disconnected before the COM loop wires are connected.

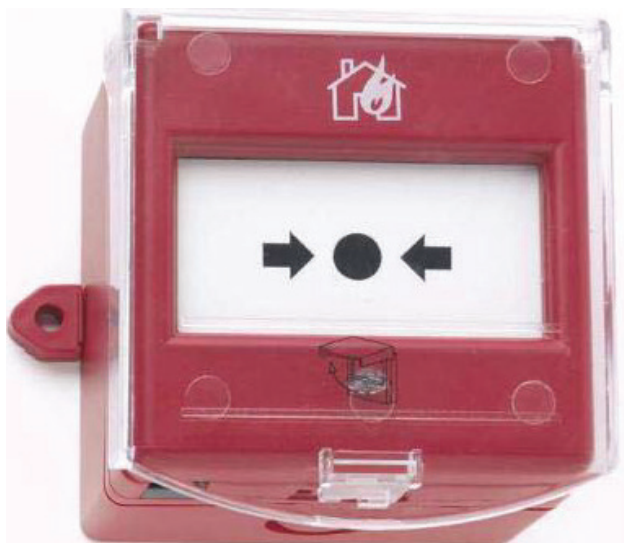

## PRODUCT APPLICATIONS

Used in the systems FT128 / FT512 / FT1020G3 and is intended for outdoor use (IP56). Must not be exposed for temp. lower than  $-25^{\circ}\text{C}$ .

## TYPE NUMBERS

<b>4439</b>	Enclosed (IP56) addressable manual call point with Isolator
<b>2347</b>	Replacement glass (10 pcs.)
<b>2348</b>	Replacement polycarbonate cover (10 pcs.)

## How to perform routine testing

1. Insert the test key into the hole in the front cover. The glass position will change, indicating that the call point is operated. Wait until the LED is turned on, i.e. fire alarm is activated in the c.i.e.
2. Pull out the test key and the glass position will return to normal. The LED will be turned off when the fire alarm is reset in the c.i.e.

## How to replace the glass element

- Lift the polycarbonate flap.
- Release the front cover security clips with the test key.
- Lift and remove the front cover. Remove the broken glass element. Place the top edge of the replacement glass element against the micro switch plunger and push it upwards until the glass element is in correct position.
- Put back the front cover and lower the polycarbonate flap. Perform a routine test.

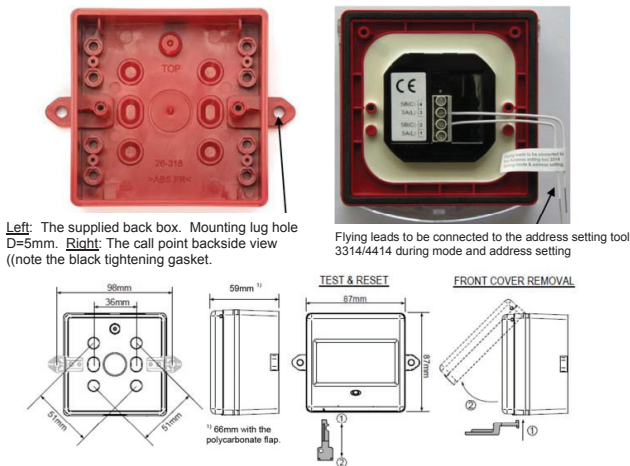

## TECHNICAL SPECIFICATIONS

Model Number	4439
Voltage (V DC) allowed nominal	12-30 24
Current consumption at nom. volt. from COM loop (mA) quiescent / active	1.6 / 2.7
Ambient temperature (°C) operating / storage	-25 to +70 / -40 to +85
Ingress Protection rating	IP56
Weight	235g
Construction / Colour	ABS / Red (ISO 3864)
Approvals	C.E:13 EC Certificate no. 0786-CPD-21236, EN54-11:2001 + A1:2005 and EN54